

Garden Sheds, Workshops Aviaries & Cubbies

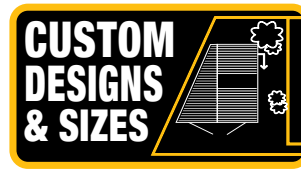

EASY TO ERECT, QUALITY PRE-ASSEMBLED PANELS



GET PRICE NOW

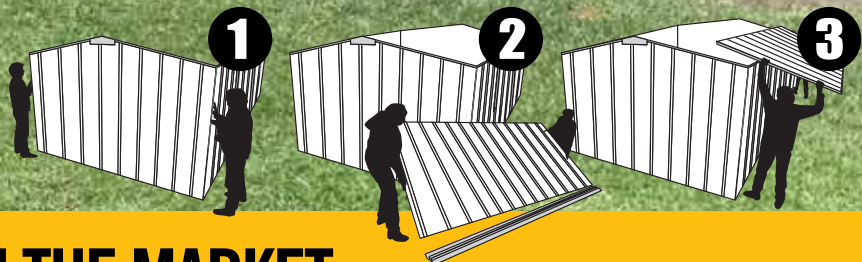

THE EASIEST DIY SHED ON THE MARKET

PLEASE SUPPORT YOUR LOCAL DISTRIBUTOR

Yes we can do custom sizes and shapes!

INSIST ON STEELCHIEF
THE ONLY SHED WITH
baseSMART®



- Eliminate unsightly trapped debris
- Eliminate premature corrosion
 - Superior N4 wind rating

Only available in SteelChief sheds.
Protect your long term investment!

BUILT TO AUSTRALIAN STANDARDS
(SPECIFICATION & COMPUTATIONS AVAILABLE)

BASESMART ELIMINATES ALL TRAPPED DEBRIS

HEAVY DUTY DEEP RIB SHEET .35MM GAUGE

0.47MM GAUGE CORRUGATED SHEET

OPTIONAL UPGRADE TO WELDED FRAME WORKSHED

LEADING PAINT SYSTEM FORMULATED FOR AUSTRALIAN CONDITIONS

LOCALLY BUILT TO YOUR REQUIREMENTS

WHY CHOOSE US?

THE  **SteelChief** DIFFERENCE
SMALL SHEDS. BIG IDEAS.

STEELCHIEF - GREAT VALUE & GREAT ADVANTAGES!

1. All of our products are locally made in Ballarat and Sydney to your requirements.
2. SteelChief sheds are a great DIY product - all shed panels are pre-assembled making your installation simple and safe.
3. Select your SteelChief product size and colour then select any of our additional optional extras. Decide on door type and positioning then build your shed exactly the way you want it. Delivery of your product will usually be within two weeks in panel form with rolled safety edges on all sheets ensuring you an excellent finished project with the minimum installation effort.

GUARANTEE

SteelChief guarantees all workmanship of our products. Our current suppliers of pre-painted coloured and zinc sheeting have warranted that their products are resistant to flaking peeling and excessive fade or perforation for 15 years under certain conditions. The warranties are given subject to our suppliers' standard warranty terms which can be found online via BlueScopes warranties calculator. We will pass on to our suppliers any material warranty claim but SteelChief will not itself be liable to meet any such claim. SteelChief may without notice change suppliers and/or materials which may alter warranty terms.

IMPORTANT NOTE

- If in doubt about the suitability of a SteelChief product for your site please consult your local civil engineer.
- Prices are current from 1st September 2021. This recommended price list replaces all other SteelChief pricing information and is subject to change without notice.
- All sizes shown are actual external wall dimensions. Roofs will overhang the walls in some directions. All measurements stated by SteelChief are nominal (or approximate) and may vary slightly from product to product. Please advise your distributor of any important dimensional requirements.
- SteelChief products are not watertight. For improved water resistance we recommend a rebated concrete floor or our rebated wooden floor option.

AT STEELCHIEF WE LIKE TO KEEP THINGS SIMPLE WITH EASY DIY

That's why all of our products come in pre-assembled panels so if you are the Do-It-Yourself kind of person upon delivery of your new SteelChief product all you need to do is screw the panels together using a cordless drill. Be sure to attach your product to the ground immediately to ensure no wind damage occurs. Instructions on assembly can be obtained from your nearest distributor or just visit us at www.steelchief.com.au to download a full step-by-step guide.



COLOUR

At SteelChief we let you be as creative with colour as you like. Mix and match any of our 10 colours for walls, door, roof and windows.

Please note: the colours below and in the example pictures are approximate shades only and should not be used for colour matching. Visit your distributor to view actual colour samples.

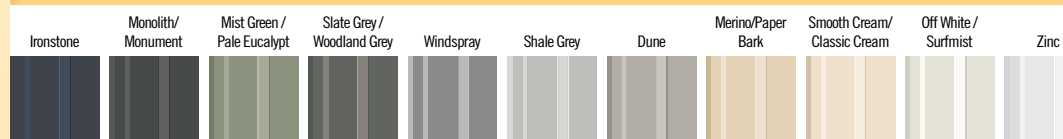

HIGHER WIND LOADINGS!

All SteelChief sheds are engineered to windclass N4

(Subject to correct installation of the shed)

Call us now for expert advice.

STEELCHIEF - INSTALLATION

Available in all major cities and some regional areas. Check with our team regarding availability

Installation by the SteelChief team includes attaching the shed to the ground with star pickets, or to your flat concrete slab with anchors and clips.

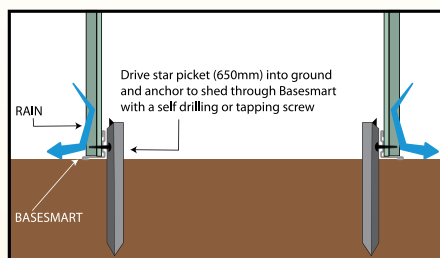

Direct To Ground Flooring Example.
(Only suitable for wind protected areas.
Not N4 rated.)

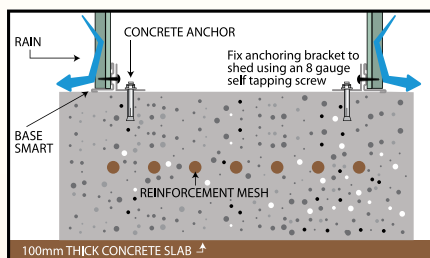

Direct To Flat Slab Example.

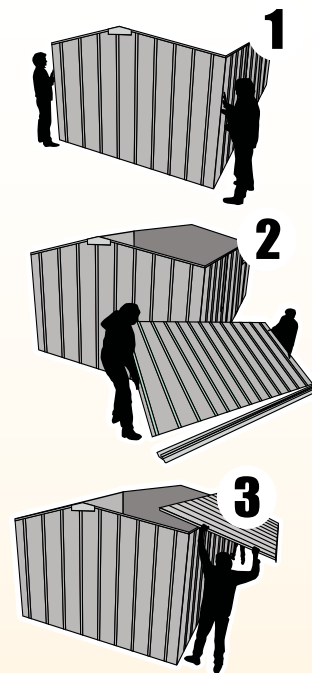

OPTIONAL SITE PREPARATION

As well as offering help when it comes to the installation of your new SteelChief product, we can also organise site preparation to ensure everything goes smoothly when we put your product up. Request a quote and we'll come and see you to survey your area. Site preparation may include minor excavation and/or retaining walls.

Setting up a site so that it's level and suitable for a concrete slab, wooden floor or direct to ground installation requires more work that

you might first think. You must use an accurate level to check the grades on your site. Also consider how water will drain around your shed. If your shed is larger than 10m² Victoria, 15m² South Australia, it may need a permit. You can check with your local council or just ask us and we can find out for you, and then obtain the permit on your behalf. For a full list of steps to ensure a prepared site just go to our website www.steelchief.com.au.

CONCRETE FLOORS

Unless you have some concreting experience, or a qualified friend who does, we do not recommend doing the concreting yourself. A mistake made can often be very expensive, and difficult to rectify. Let the Steel Chief team take the hassle out and do it for you, and also lay any other surrounding pathways etc.

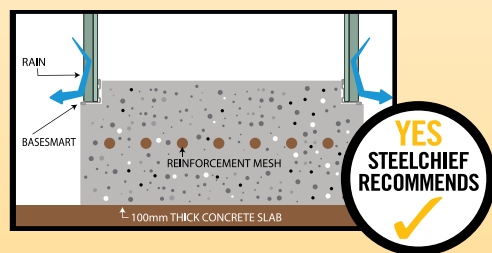

REBATED CONCRETE SLAB (MAXIMISES WATER TIGHTNESS)

Concrete floors are a great shed base option. Allow the concrete to dry for forty-eight hours before using the shed! The finished slab size is the same size as the shed, but upon request additional concreting around the shed can be done.

- Concrete and shed installation completed same day
- Suitable for relatively flat sites

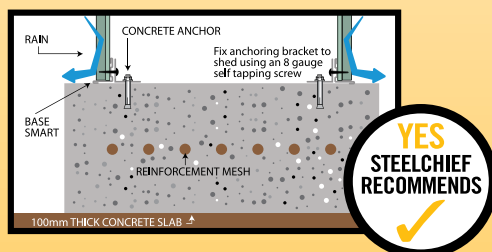

FLAT CONCRETE SLAB

The shed is bolted to the flat slab. In this option you may want to seal around the base of the shed. We will pour the slab and return at a later date to erect the shed. If you require us to seal the base of the shed please request a quote. Note: The silicone seal around the shed base is usually good but in some circumstances it can leak water.

- Suitable for flat and sites with a fall
- Sheds can be sealed internally with silicon type bead
- Bolt shed to slab using concrete clips
- Slab poured then shed installed at a later date

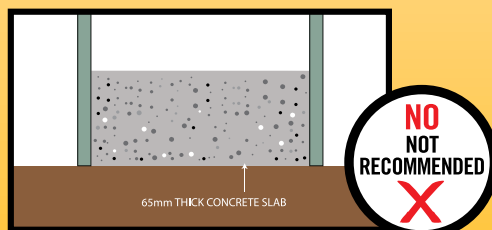

INFILL POUR SLAB

- Concrete flows inside ribs and voids sheet warranty . Premature corrosion may occur
- Damaged shed usually requires concrete floor to be removed and replaced. Very expensive.
- Loss of 65m m headroom

Yes we can do custom sizes and shapes!

CUSTOM & PREFERRED SIZING

HEAVY DUTY SHEETS AND PAN SIZES

Size Meters	Panel Makeup	Size Meters	Panel Makeup	Size Meters	Panel Makeup	Size Meters	Panel Makeup
0.23	1 Pan	2.54	3 Sheet 1 Pan	4.85	6 Sheet 1 Pan	7.16	9 Sheet 1 Pan
0.43	2 Pans	2.74	3 Sheet 2 Pan	5.05	6 Sheet 2 Pan	7.36	9 Sheet 2 Pan
0.62	3 Pans	2.93	3 Sheet 3 Pan	5.24	6 Sheet 3 Pan	7.55	9 Sheet 3 Pan
0.81	1 Sheet	3.12	4 Sheets	5.43	7Sheets	7.74	10 Sheets
1.00	1 Sheet 1 Pan	3.31	4 Sheet 1 Pan	5.62	7 Sheet 1 Pan	7.93	10 Sheet 1 Pan
1.20	1 Sheet 2 Pan	3.51	4 Sheet 2 Pan	5.82	7 Sheet 2 Pan	8.13	10 Sheet 2 Pan
1.39	1 Sheet 3 Pan	3.70	4 Sheet 3 Pan	6.01	7 Sheet 3 Pan	8.32	10 Sheet 3 Pan
1.58	2 Sheets	3.89	5 Sheets	6.20	8 Sheets	8.51	11 Sheets
1.77	2 Sheet 1 Pan	4.08	5 Sheet 1 Pan	6.39	8 Sheet 1 Pan	8.70	11 Sheet 1 Pan
1.97	2 Sheet 2 Pan	4.28	5 Sheet 2 Pan	6.59	8 Sheet 2 Pan	8.90	11 Sheet 2 Pan
2.16	2 Sheet 3 Pan	4.47	5 Sheet 3 Pan	6.78	8 Sheet 3 Pan	9.09	11 Sheet 3 Pan
2.35	3 Sheets	4.66	6 Sheets	6.97	9 Sheets	9.28	12 Sheets

Standards sizes - Quote out of tables

Preferred Size - Take next standard size up from the tables and add additional charge

Heavy Duty \$145.00

SteelFrame Workshop \$190.00

Must Be Sizes - Any size inbetween take next standard sheet size up from the tables and add additional charge

Heavy Duty \$245.00

SteelFrame Workshop \$265.00

CORRUGATED SHEETS AND RIBS SIZES

Size Meters	Panel Makeup	Size Meters	Panel Makeup	Size Meters	Panel Makeup	Size Meters	Panel Makeup
0.135	2 Ribs	2.035	2 Sheets 6 Ribs	3.935	5 Sheets 1 Rib	5.835	7 Sheets 6 Ribs
0.215	3 Ribs	2.115	2 Sheets 7 Ribs	4.015	5 Sheets 2 Ribs	5.910	7 Sheets 7 Ribs
0.290	4 Ribs	2.190	2 Sheets 8 Ribs	4.090	5 Sheets 3 Ribs	5.990	7 Sheets 8 Ribs
0.365	5 Ribs	2.265	2 Sheets 9 Ribs	4.165	5 Sheets 4 Ribs	6.065	7 Sheets 9 Ribs
0.440	6 Ribs	2.340	3 Sheets	4.240	5 Sheets 5 Ribs	6.140	8 Sheets
0.515	7 Ribs	2.415	3 Sheets 1 Rib	4.315	5 Sheets 6 Ribs	6.215	8 Sheets 1 Rib
0.590	8 Ribs	2.490	3 Sheets 2 Ribs	4.390	5 Sheets 7 Ribs	6.290	8 Sheets 2 Ribs
0.670	9 Ribs	2.570	3 Sheets 3 Ribs	4.470	5 Sheets 8 Ribs	6.370	8 Sheets 3 Ribs
0.745	10 Ribs	2.645	3 Sheets 4 Ribs	4.545	5 Sheets 9 Ribs	6.445	8 Sheets 4 Ribs
0.820	1 Sheet	2.720	3 Sheets 5 Ribs	4.620	6 Sheets	6.520	8 Sheets 5 Ribs
0.895	1 Sheet 1 Rib	2.795	3 Sheets 6 Ribs	4.695	6 Sheets 1 Rib	6.595	8 Sheets 6 Ribs
0.970	1 Sheet 2 Ribs	2.870	3 Sheets 7 Ribs	4.770	6 Sheets 2 Ribs	6.670	8 Sheets 7 Ribs
1.050	1 Sheet 3 Ribs	2.950	3 Sheets 8 Ribs	4.850	6 Sheets 3 Ribs	6.750	8 Sheets 8 Ribs
1.125	1 Sheet 4 Ribs	3.025	3 Sheets 9 Ribs	4.925	6 Sheets 4 Ribs	6.825	8 Sheets 9 Ribs
1.200	1 Sheet 5 Ribs	3.100	4 Sheets	5.000	6 Sheets 5 Ribs	6.900	9 Sheets
1.275	1 Sheet 6 Ribs	3.175	4 Sheets 1 Rib	5.075	6 Sheets 6 Ribs	6.975	9 Sheets 1 Rib
1.350	1 Sheet 7 Ribs	3.250	4 Sheets 2 Ribs	5.150	6 Sheets 7 Ribs	7.050	9 Sheets 2 Ribs
1.430	1 Sheet 8 Ribs	3.330	4 Sheets 3 Ribs	5.230	6 Sheets 8 Ribs	7.130	9 Sheets 3 Ribs
1.505	1 Sheet 9 Ribs	3.405	4 Sheets 4 Ribs	5.305	6 Sheets 9 Ribs	7.205	9 Sheets 4 Ribs
1.580	2 Sheets	3.480	4 Sheets 5 Ribs	5.380	7 Sheets	7.280	9 Sheets 5 Ribs
1.650	2 Sheets 1 Rib	3.555	4 Sheets 6 Ribs	5.455	7 Sheets 1 Rib	7.355	9 Sheets 6 Ribs
1.730	2 Sheets 2 Ribs	3.630	4 Sheets 7 Ribs	5.530	7 Sheets 2 Ribs	7.430	9 Sheets 7 Ribs
1.810	2 Sheets 3 Ribs	3.710	4 Sheets 8 Ribs	5.610	7 Sheets 3 Ribs	7.510	9 Sheets 8 Ribs
1.885	2 Sheets 4 Ribs	3.785	4 Sheets 9 Ribs	5.685	7 Sheets 4 Ribs	7.585	9 Sheets 9 Ribs
1.960	2 Sheets 5 Ribs	3.860	5 Sheets	5.760	7 Sheets 5 Ribs	7.660	10 Sheets

Standards sizes - Quote out of tables

Preferred Size - Take next standard size up from the tables and add additional \$260

Must Be Sizes - Any size inbetween take next standard sheet size up from the tables and add additional \$365

Call us now for expert advice.

GABLE ROOF RANGE



HEAVY DUTY GABLE ROOF PRICING

Gable m	Zinc				Colour			
	1.58	2.35	3.12	3.89	1.58	2.35	3.12	3.89
1.58	\$885	\$1,049	\$1,219	\$1,389	\$975	\$1,175	\$1,369	\$1,569
2.35	\$1,099	\$1,285	\$1,469	\$1,649	\$1,219	\$1,435	\$1,655	\$1,869
3.12	\$1,315	\$1,515	\$1,715	\$1,915	\$1,459	\$1,699	\$1,939	\$2,169
3.89	\$1,529	\$1,749	\$1,965	\$2,175	\$1,705	\$1,965	\$2,219	\$2,469
4.66	\$1,959	\$2,205	\$2,449	\$2,685	\$2,159	\$2,449	\$2,739	\$3,015
5.43	\$2,175	\$2,435	\$2,699	\$2,945	\$2,399	\$2,715	\$3,025	\$3,315
6.20	\$2,389	\$2,669	\$2,945	\$3,205	\$2,645	\$2,975	\$3,309	\$3,615
6.97	\$2,609	\$2,899	\$3,195	\$3,465	\$2,885	\$3,239	\$3,589	\$3,915
7.74	\$2,825	\$3,135	\$3,445	\$3,729	\$3,129	\$3,505	\$3,875	\$4,215

Standard includes single hinged or sliding door in front and wall height 1800mm.

HEAVY DUTY GABLE ROOF WITH TRIPLE DOORS PRICING

Front x gable	Zinc	Colour	Front x gable	Zinc	Colour
4.66m x 3.12m	\$2,629	\$2,919	7.74m x 3.12m	\$3,625	\$4,055
5.43m x 3.12m	\$2,879	\$3,205			
6.20m x 3.12m	\$3,125	\$3,489			

PICTURES:

A 3.12 x 3.12 Gable. Including optional double doors.
Zinc **\$1820** Colour **\$2044**

B 4.66 x 3.89m Gable. Including optional two windows and double doors gable end.
Zinc **\$3252** Colour **\$3582**

C 3.12 x 3.12m Gable.
Zinc **\$1715** Colour **\$1939**

E 6.20 x 3.12m Gable. Including optional extra double doors (triple doors). Zinc **\$3125** Colour **\$3489**

F 4.66m x 3.12m Gable. Including optional extra double doors (triple doors).
Zinc **\$2629** Colour **\$2919**

Height to top of gable:

Wall Height 1.80 1.95 2.10

Gable m

1.58 2.00 2.15 2.30

2.35 2.08 2.23 2.38

3.12 2.15 2.30 2.45

3.89 2.23 2.38 2.53

Gable Roof Range Notes:

1. Standard door position is in any sheet front or back.
2. Other door options longer and shorter fronts are available.
3. Extra wall heights are available.
4. Roof truss supplied for fronts exceeding 3.89m.

MAXIMISE USE OF THAT DEAD SPACE!

TRAPEZOID SHED!

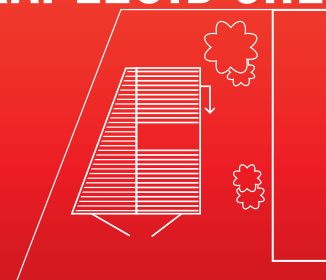

MEASURE UP AND ASK FOR A QUOTE TODAY

SEE PAGE 2 TO SELECT COLOURS FOR WALLS DOORS ROOF & WINDOWS! MIX AND MATCH ANY COLOURS YOU LIKE!
SEE PAGE 22-23 TO SELECT FLOOR DOOR WINDOW EXTRA WALL HEIGHT OPTIONS ETC.

Call: VIC 03 5334 1954 NSW: 02 4623 4222 ADELAIDE: 1300 130 102 or VISIT www.steelchief.com.au

Yes we can do custom sizes and shapes!

SKILLION ROOF RANGE



HEAVY DUTY SKILLION ROOF PRICING

Skillion m	Zinc			Colour		
	0.81	1.58	2.35	0.81	1.58	2.35
Front m						
1.58	\$665	\$825	\$985	\$729	\$919	\$1,105
2.35	\$835	\$1,015	\$1,189	\$929	\$1,139	\$1,339
3.12	\$1,009	\$1,205	\$1,389	\$1,125	\$1,359	\$1,575
3.89	\$1,179	\$1,395	\$1,595	\$1,319	\$1,575	\$1,809
4.66	\$1,355	\$1,585	\$1,799	\$1,519	\$1,795	\$2,045
5.43	\$1,529	\$1,775	\$1,999	\$1,715	\$2,009	\$2,279
6.20	\$1,699	\$1,965	\$2,205	\$1,909	\$2,229	\$2,515
6.97	\$1,875	\$2,155	\$2,405	\$2,109	\$2,449	\$2,749
7.74	\$2,045	\$2,345	\$2,609	\$2,305	\$2,665	\$2,985

PICTURES:

- G** 1.58 x 1.58m Skillion Side. Zinc **\$825** Colour **\$919**
- H** 2.35m x 1.58m Skillion optional double hinged doors +300mm wall height Zinc **\$1323** Colour **\$1471**
- I** 3.12 x 0.41m Skillion Side. Including optional extra double doors and custom size to 0.41m side. Zinc **\$1434** Colour **\$1550**

Standard includes single hinged or sliding door in front or back and wall heights of 1950mm / 1800mm.

Skillion Roof Range Notes:

1. Standard door position is any sheet position front or back.
2. Other door options and extra wall height available.
3. Standard skillion front wall 1950mm high back wall 1800mm high.
4. Longer fronts available.



PUMP HOUSE

LARGE

1.58m x 1.39m x 1310mm High.
Zinc **\$1120** Colour **\$1444**

MEDIUM as pictured.

1.58m x 1.20m x 1310mm High.
Zinc **\$936** Colour **\$1244**

SMALL

1.58m x 0.81m x 1310mm High
Narrow single door. Bar required above door.
Zinc **\$720** Colour **\$948**

Pump House Notes:

1. Supplied as 5 pre-assembled panels.
2. Roof hinged.
3. Single hinged door in front.
4. Other sizes are available please request a quote to your exact requirements.
5. Available in all SteelChief colours.

**DON'T WASTE THAT SPACE!
TRY ONE OF OUR
TRIANGULAR SHEDS!**



MEASURE UP AND ASK FOR A QUOTE TODAY

Call us now for expert advice.

HERITAGE ROOF RANGE

HEAVY DUTY HERITAGE ROOF PRICING

Gable m Front m	Zinc		Colour	
	1.58	2.35	1.58	2.35
1.58	\$1,175	\$1,369	\$1,289	\$1,519
2.35	\$1,435	\$1,655	\$1,585	\$1,839
3.12	\$1,695	\$1,939	\$1,879	\$2,155
3.89	\$1,955	\$2,225	\$2,169	\$2,475
4.66	\$2,535	\$3,059	\$2,779	\$3,349
5.43	\$2,795	\$3,345	\$3,075	\$3,665
6.20	\$3,055	\$3,629	\$3,365	\$3,985
6.97	\$3,315	\$3,915	\$3,659	\$4,305
7.74	\$3,579	\$4,199	\$3,949	\$4,625

Standard includes single hinged or sliding door in front and wall height of 1950mm.



J HERITAGE ROOF

Heavy Duty Construction as pictured.
Front 2.35 x gable 1.58m.

Options Louvre window in front

ZINC **\$1614**

COLOUR **\$1764**

Heritage Roof Range Notes:

1. Standard door position is in any sheet front or back.
2. Other door options longer and shorter fronts are available.
3. Extra wall height is not available.
4. Roof truss supplied for fronts exceeding 3.89m.
5. Height to top of gable is: 1.58m gable 2.44m and 2.35m gable 2.63m.
6. Heritage door height is 1830mm.

FLAT ROOF RANGE

HEAVY DUTY FLAT ROOF PRICING

Side m Front m	Zinc		Colour	
	0.81	1.58	0.81	1.58
1.58	\$649	\$805	\$715	\$895
2.35	\$819	\$995	\$905	\$1,109
3.12	\$989	\$1,179	\$1,099	\$1,325
3.89	\$1,159	\$1,365	\$1,295	\$1,539
4.66	\$1,329	\$1,555	\$1,485	\$1,755
5.43	\$1,499	\$1,739	\$1,679	\$1,969
6.20	\$1,669	\$1,929	\$1,869	\$2,185
6.97	\$1,839	\$2,115	\$2,065	\$2,395
7.74	\$2,009	\$2,299	\$2,259	\$2,609

Standard includes single hinged or sliding door in front and wall height of 1800mm.

L FLAT ROOF

Heavy Duty Construction as pictured
Front 2.35m x side 0.81m.

Options: Double hinged doors in front and extra single door in side.

ZINC **\$1029** COLOUR **\$1115**

Flat Roof Range Notes:

1. Other door options and extra wall heights available.
2. Longer fronts available.



SEE PAGE 2 TO SELECT COLOURS FOR WALLS DOORS ROOF & WINDOWS! MIX AND MATCH ANY COLOURS YOU LIKE!
SEE PAGE 22-23 TO SELECT FLOOR DOOR WINDOW EXTRA WALL HEIGHT OPTIONS ETC.

Yes we can do custom sizes and shapes!

"Hi I'm back ... good old fashioned corrugated!"

CORRUGATED SHED RANGE

- ✓ Heavy Duty Steel 0.47mm Gauge.
- ✓ 24 Colours Available.
- ✓ Basesmart Technology.
- ✓ Supplied as Pre-Assembled Panels.



PICTURE C1:
4.62 x 2.34 Gable optional 2.10m wall height with double doors
Zinc \$4099 Colour \$3944



C1

CORRUGATED GABLE ROOF PRICING

Gable m	Zinc				Colour			
	1.58	2.34	3.10	3.86	1.58	2.34	3.10	3.86
1.58	\$1,359	\$1,659	\$1,969	\$2,289	\$1,295	\$1,609	\$1,899	\$2,229
2.34	\$1,705	\$2,025	\$2,375	\$2,715	\$1,625	\$1,965	\$2,309	\$2,665
3.10	\$2,025	\$2,405	\$2,759	\$3,095	\$1,939	\$2,325	\$2,715	\$3,065
3.86	\$2,369	\$2,759	\$3,169	\$3,555	\$2,265	\$2,679	\$3,089	\$3,479
4.62	\$2,889	\$3,329	\$3,799	\$4,205	\$2,749	\$3,199	\$3,679	\$4,105
5.38	\$3,229	\$3,705	\$4,199	\$4,659	\$3,075	\$3,575	\$4,079	\$4,539
6.14	\$3,555	\$4,065	\$4,599	\$5,085	\$3,399	\$3,925	\$4,469	\$4,959
6.90	\$3,875	\$4,435	\$4,995	\$5,509	\$3,715	\$4,279	\$4,865	\$5,379
7.66	\$4,205	\$4,809	\$5,405	\$5,925	\$4,045	\$4,649	\$5,259	\$5,819

Standard includes single sliding or hinged door in front and wall height of 1800mm

Gable Roof Range Notes:

1. Standard door position is in any sheet front or back.
2. Other door options longer and shorter fronts are available.
3. Extra wall heights are available.
4. Roof truss supplied for fronts exceeding 3.86m.

CORRUGATED SKILLION ROOF PRICING

Gable m	Zinc			Colour		
	0.82	1.58	2.34	0.82	1.58	2.34
0.82	\$749	\$1,015	\$1,339	\$699	\$965	\$1,285
1.58	\$1,039	\$1,335	\$1,715	\$985	\$1,285	\$1,635
2.34	\$1,319	\$1,645	\$2,059	\$1,259	\$1,609	\$1,985
3.10	\$1,589	\$1,969	\$2,405	\$1,529	\$1,919	\$2,339
3.86	\$1,895	\$2,309	\$2,775	\$1,815	\$2,229	\$2,715
4.62	\$2,159	\$2,609	\$3,339	\$2,089	\$2,545	\$3,225
5.38	\$2,439	\$2,925	\$3,705	\$2,375	\$2,855	\$3,575
6.14	\$2,729	\$3,265	\$4,045	\$2,635	\$3,185	\$3,925
6.90	\$2,999	\$3,565	\$4,409	\$2,919	\$3,499	\$4,279
7.66	\$3,305	\$3,905	\$4,759	\$3,199	\$3,819	\$4,629

Standard includes single sliding or hinged door in front and wall heights of 1950mm / 1800mm.



C2

PICTURE C2:
3.10m x 0.81m Skillion optional double sliding doors plus 300mm wall height
Zinc \$2011 Colour \$1940

Skillion Roof Range Notes:

1. Standard door position is any sheet position front or back.
2. Other door options and extra wall height available.
3. Standard skillion front wall 1950mm high back wall 1800mm high.
4. Longer fronts available.

CORRUGATED HERITAGE ROOF PRICING

Side m	Zinc		Colour	
	1.58	2.34	1.58	2.34
1.58	\$1,699	\$2,119	\$1,619	\$2,025
2.34	\$2,059	\$2,609	\$1,985	\$2,495
3.10	\$2,409	\$3,075	\$2,329	\$2,935
3.86	\$2,795	\$3,555	\$2,715	\$3,399
4.62	\$3,455	\$4,325	\$3,305	\$4,089
5.38	\$3,815	\$4,809	\$3,679	\$4,549
6.14	\$4,199	\$5,295	\$4,039	\$5,025
6.90	\$4,565	\$5,769	\$4,415	\$5,485
7.66	\$4,949	\$6,269	\$4,779	\$5,955

Standard includes single sliding or hinged door in front and wall height of 1950mm

Heritage Roof Range Notes:

1. Standard door position is in any sheet front or back.
2. Other door options longer and shorter fronts are available.
3. Extra wall height is not available.
4. Roof truss supplied for fronts exceeding 3.86m.
5. Height to top of gable is: 1.58m gable 2.44m and 2.34m gable 2.63m.
6. Heritage door height is 1830mm.

CORRUGATED FLAT ROOF PRICING

Side m	Zinc		Colour	
	0.82	1.58	0.82	1.58
0.82	\$729	\$969	\$685	\$919
1.58	\$985	\$1,279	\$929	\$1,219
2.34	\$1,259	\$1,585	\$1,189	\$1,529
3.10	\$1,515	\$1,895	\$1,449	\$1,829
3.86	\$1,775	\$2,199	\$1,709	\$2,135
4.62	\$2,039	\$2,485	\$1,969	\$2,439
5.38	\$2,309	\$2,805	\$2,229	\$2,745
6.14	\$2,559	\$3,095	\$2,485	\$3,045
6.90	\$2,805	\$3,419	\$2,749	\$3,339
7.66	\$3,079	\$3,719	\$3,009	\$3,655

Standard includes single sliding or hinged door in front and wall height of 1800mm



C3

PICTURE C3:
3.1m x 1.58m Flat. Zinc \$1895 Colour \$1829

Flat Roof Range Notes:

1. Standard door position is any sheet position front or back.
2. Other door options and extra wall heights available.
3. Longer fronts available.

WHY UPGRADE TO STEEL FRAME

All steel frame sheds are supplied as pre-assembled wall and roof panels

Sheet fixed to frame using Aircraft grade Aluminium rivets as standard to all sheds

PA Doors & Door opening fully welded RHS, with heavy duty hinges

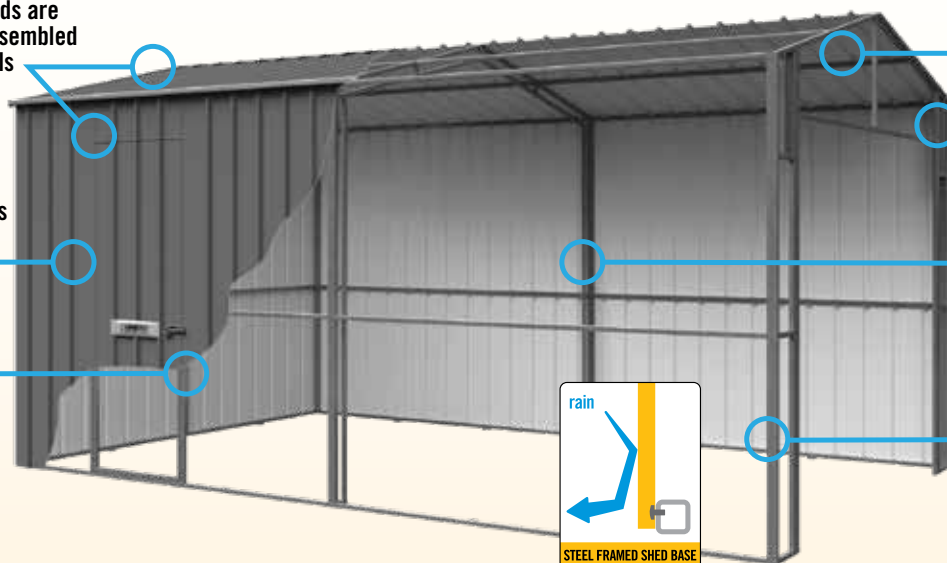

Roof bars to sheds over 2.34m gable span

Steel mounting plates for roller door models

Full height portal with hold down brackets for shed over 3.86m in length

Steel frame sheds feature a strong Galvanised 25 x 25mm RHS steel frame, fully MIG welded

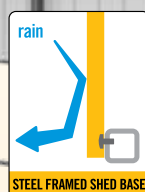

ROLLER DOOR STORAGE SHEDS

EASIER ACCESS, BETTER SECURITY, IDEAL FOR LIMITED SPACE, PREMIUM LOOKING.

POPULAR ROLLER DOOR SHED SIZES

HEAVY DUTY SHEET PROFILE

Gable

Gable m Front m	Zinc		Colour	
	3.89	4.66	3.89	4.66
4.66	\$7,444	\$8,495	\$7,766	\$9,848
5.43	\$7,827	\$8,987	\$8,180	\$10,465
6.2	\$8,212	\$9,477	\$8,595	\$11,082

Standard includes 3000mmW roller door and wall height of 2410mmH

Skillion / Flat

Side m Front m	Zinc		Colour	
	0.81	1.58	0.81	1.58
2.35	\$3,082	\$3,343	\$3,155	\$3,440
3.12	\$3,450	\$3,719	\$3,540	\$3,841
3.89	\$4,081	\$4,362	\$4,198	\$4,503

Standard includes roller door width to suit front length - see notes wall height of 2410mm/2360mm

CORRUGATED SHEET PROFILE

Corri Gable

Gable m Front m	Zinc		Colour	
	3.86	4.62	3.86	4.62
4.62	\$9,030	\$10,226	\$9,083	\$10,085
5.38	\$9,664	\$10,964	\$9,754	\$10,808
6.14	\$10,298	\$11,704	\$10,445	\$11,531

Standard includes 3000mmW roller door and wall height of 2410mmH

Corri Skillion / Flat

Side m Front m	Zinc		Colour	
	0.82	1.58	0.82	1.58
2.34	\$3,899	\$4,326	\$3,802	\$4,277
3.10	\$4,431	\$4,895	\$4,353	\$4,858
3.86	\$5,228	\$5,736	\$5,167	\$5,728

Standard includes roller door width to suit front length - see notes wall height of 2410mm/2360mm

Roller door openings:

- 1800mm W x 1950mm H (2.35m front)
- 2400mm W x 1950mm H (3.12m front)
- 3000mm W x 1950mm H (3.89m front)

NOTE: Roller Door Storage Shed must be attached at the base to a 100mm reinforced concrete foundation using 6.5mm diameter sleeve anchors in all anchor brackets.



ROLLER DOOR SHED PRICE CALCULATOR

+ + +

+ + +

Find the size shed you want and get the price from pages 10 or 11

For 600mm extra wall height required on all Roller Door Storage Sheds

Select roller door width
1.8m width add \$965
2.4m width add \$1065
3.0m width add \$1435

Add other options from page 22-23



Comes as Standard with Extra Strong Welded Steel Frame Construction

Yes we can do custom sizes and shapes!

HEAVY DUTY WITH WELDED FRAME

GABLE ROOF WORK SHED PRICING

Gable m	Zinc					Colour				
	1.58	2.35	3.12	3.89	4.66	1.58	2.35	3.12	3.89	4.66
1.58	\$1,815	\$2,015	\$2,255	\$2,469	\$3,238	\$1,875	\$2,089	\$2,355	\$2,589	\$3,858
2.35	\$2,075	\$2,289	\$2,569	\$2,785	\$3,607	\$2,155	\$2,389	\$2,689	\$2,929	\$4,328
3.12	\$2,335	\$2,569	\$2,885	\$3,099	\$3,977	\$2,429	\$2,685	\$3,029	\$3,269	\$4,798
3.89	\$2,595	\$2,845	\$3,199	\$3,415	\$4,347	\$2,705	\$2,979	\$3,369	\$3,609	\$5,269
4.66	\$3,359	\$3,645	\$4,055	\$4,295	\$5,431	\$3,485	\$3,799	\$4,249	\$4,509	\$6,511
5.43	\$3,619	\$3,919	\$4,369	\$4,609	\$5,801	\$3,765	\$4,095	\$4,589	\$4,849	\$6,981
6.2	\$3,879	\$4,199	\$4,685	\$4,925	\$6,170	\$4,039	\$4,395	\$4,929	\$5,189	\$7,452
6.97	\$4,139	\$4,475	\$4,999	\$5,239	\$6,540	\$4,319	\$4,689	\$5,265	\$5,529	\$7,922
7.74	\$4,399	\$4,755	\$5,315	\$5,555	\$6,910	\$4,595	\$4,989	\$5,605	\$5,869	\$8,393
8.51	\$5,159	\$5,555	\$6,169	\$6,429	\$7,994	\$5,375	\$5,809	\$6,489	\$6,769	\$9,635
9.28	\$5,425	\$5,829	\$6,485	\$6,749	\$8,364	\$5,649	\$6,105	\$6,829	\$7,109	\$10,105

Standard includes single hinged or sliding door in front and wall height of 1810mm



SKILLION ROOF WORK SHED PRICING

Skillion m	Zinc			Colour		
	0.81	1.58	2.35	0.81	1.58	2.35
1.58	\$1,515	\$1,729	\$1,899	\$1,559	\$1,789	\$1,979
2.35	\$1,735	\$1,949	\$2,145	\$1,795	\$2,029	\$2,239
3.12	\$1,955	\$2,175	\$2,385	\$2,029	\$2,275	\$2,505
3.89	\$2,169	\$2,399	\$2,629	\$2,265	\$2,515	\$2,769
4.66	\$2,655	\$2,889	\$3,395	\$2,765	\$3,019	\$3,555
5.43	\$2,875	\$3,109	\$3,639	\$2,999	\$3,265	\$3,815
6.2	\$3,095	\$3,335	\$3,879	\$3,235	\$3,505	\$4,079
6.97	\$3,309	\$3,559	\$4,119	\$3,469	\$3,749	\$4,339
7.74	\$3,529	\$3,779	\$4,365	\$3,705	\$3,989	\$4,605
8.51	\$4,015	\$4,269	\$5,129	\$4,205	\$4,495	\$5,389
9.28	\$4,235	\$4,495	\$5,375	\$4,439	\$4,739	\$5,649

Standard includes single hinged or sliding door in front or back and wall heights of 1960mm / 1810mm.



FLAT ROOF WORK SHED PRICING

Side m	Zinc		Colour	
	0.81	1.58	0.81	1.58
0.81	\$1,355	\$1,505	\$1,385	\$1,545
1.58	\$1,559	\$1,729	\$1,605	\$1,785
2.35	\$1,769	\$1,949	\$1,825	\$2,025
3.12	\$1,975	\$2,175	\$2,045	\$2,269
3.89	\$2,179	\$2,395	\$2,269	\$2,509
4.66	\$2,649	\$2,885	\$2,755	\$3,009
5.43	\$2,855	\$3,105	\$2,975	\$3,255
6.2	\$3,065	\$3,325	\$3,195	\$3,489
6.97	\$3,269	\$3,549	\$3,419	\$3,735
7.74	\$3,475	\$3,775	\$3,639	\$3,969
8.51	\$3,945	\$4,259	\$4,125	\$4,475
9.28	\$4,155	\$4,479	\$4,345	\$4,715

Standard includes single hinged or sliding door in front. Wall height 1810mm

HERITAGE ROOF WORK SHED PRICING

Side m	Zinc		Colour	
	1.58	2.35	1.58	2.35
1.58	\$1,935	\$2,135	\$2,005	\$2,225
2.35	\$2,195	\$2,399	\$2,285	\$2,515
3.12	\$2,455	\$2,669	\$2,569	\$2,805
3.89	\$2,715	\$2,939	\$2,849	\$3,095
4.66	\$3,239	\$3,729	\$3,639	\$3,905
5.43	\$3,505	\$3,999	\$3,925	\$4,195
6.2	\$3,765	\$4,269	\$4,205	\$4,489
6.97	\$4,025	\$4,535	\$4,489	\$4,779
7.74	\$4,285	\$4,805	\$4,769	\$5,065
8.51	\$4,809	\$5,595	\$5,559	\$5,875
9.28	\$5,075	\$5,865	\$5,839	\$6,165

Standard includes single hinged or sliding door in front wall height of 1960mm.

Work Shed Range Notes:

1. Longer and shorter fronts and made to order sizes are available on request.
2. Internal portal supplied for fronts exceeding 3.89m.
3. Roof bars supplied to gables 3.12m and above.
4. Steel framed sheds supplied with loose fixing brackets.
5. Roller door only available in steel frame construction. Minimum wall height 2.25m height of opening 1.85m. Maximum wall height 2.4m height of opening 1.95m. Maximum door width 3.0m. Request a quote or see page 18 for roller door pricing.
6. All roofs are non-trafficable. Request a separate quote if a trafficable roof required.

Height to top of gable:

Wall Height	1.80m	1.95m	2.10m	2.40m
Gable m				
1.58	2.01	2.16	2.31	2.61
2.35	2.09	2.24	2.39	2.69
3.12	2.16	2.31	2.46	2.76
3.89	2.24	2.39	2.54	2.84

PICTURES:

- N 6.20 x 3.12m SF Gable. Including optional extra garage doors window 2 x skylights and extra wall height (plus 300mm). Zinc \$6441 Colour \$6619
- O 3.12 x 3.12m SF Gable. Including optional double door gable end. Zinc \$3140 Colour \$3284
- P 2.35 x 1.58m SF Skillion. Including optional extra large door in skillion end one four-arm x 2.2m steel shelf set and two shovel racks. Zinc \$2356 Colour \$2436
- Q Roller door shed see page 6.



Call us now for expert advice.

CORRUGATED SHEET PROFILE

CORRUGATED STEEL FRAME GABLE ROOF PRICING

Gable m Front m	Zinc					Colour				
	1.58	2.34	3.10	3.86	4.62	1.58	2.34	3.10	3.86	4.62
1.58	\$2,495	\$2,869	\$3,269	\$3,629	\$4,309	\$2,399	\$2,809	\$3,239	\$3,625	\$4,244
2.34	\$2,925	\$3,319	\$3,775	\$4,149	\$4,915	\$2,845	\$3,285	\$3,765	\$4,169	\$4,837
3.10	\$3,355	\$3,785	\$4,265	\$4,669	\$5,520	\$3,285	\$3,765	\$4,269	\$4,725	\$5,430
3.86	\$3,785	\$4,229	\$4,769	\$5,199	\$6,126	\$3,719	\$4,225	\$4,799	\$5,285	\$6,022
4.62	\$4,649	\$5,149	\$5,755	\$6,225	\$7,206	\$4,545	\$5,115	\$5,759	\$6,269	\$7,090
5.38	\$5,079	\$5,615	\$6,245	\$6,745	\$7,811	\$4,995	\$5,595	\$6,285	\$6,819	\$7,683
6.14	\$5,495	\$6,055	\$6,759	\$7,265	\$8,417	\$5,435	\$6,065	\$6,809	\$7,385	\$8,275
6.90	\$5,915	\$6,515	\$7,249	\$7,779	\$9,022	\$5,869	\$6,539	\$7,335	\$7,919	\$8,868
7.66	\$6,345	\$6,969	\$7,739	\$8,315	\$9,628	\$6,299	\$7,019	\$7,845	\$8,475	\$9,461

Standard includes single hinged or sliding door in front and wall height of 1810mm



CORRUGATED STEEL FRAME SKILLION ROOF PRICING

Gable m Front m	Zinc			Colour		
	0.82	1.58	2.34	0.82	1.58	2.34
0.82	\$1,699	\$1,979	\$2,315	\$1,575	\$1,889	\$2,235
1.58	\$2,035	\$2,365	\$2,735	\$1,945	\$2,295	\$2,695
2.34	\$2,405	\$2,755	\$3,139	\$2,325	\$2,715	\$3,139
3.10	\$2,759	\$3,139	\$3,565	\$2,695	\$3,109	\$3,569
3.86	\$3,109	\$3,525	\$3,989	\$3,059	\$3,519	\$4,019
4.62	\$3,679	\$4,119	\$4,889	\$3,619	\$4,115	\$4,889
5.38	\$4,025	\$4,495	\$5,309	\$3,975	\$4,519	\$5,325
6.14	\$4,389	\$4,889	\$5,705	\$4,345	\$4,935	\$5,789
6.90	\$4,745	\$5,269	\$6,129	\$4,725	\$5,345	\$6,225
7.66	\$5,095	\$5,665	\$6,559	\$5,095	\$5,759	\$6,669

Standard includes single hinged or sliding door in front and wall heights of 1960mm / 1810mm.



CORRUGATED STEEL FRAME FLAT ROOF PRICING

Side m Front m	Zinc		Colour	
	0.82	1.58	0.82	1.58
0.82	\$1,645	\$1,979	\$1,545	\$1,869
1.58	\$2,009	\$2,365	\$1,909	\$2,285
2.34	\$2,365	\$2,735	\$2,269	\$2,695
3.10	\$2,699	\$3,125	\$2,639	\$3,095
3.86	\$3,055	\$3,505	\$2,995	\$3,495
4.62	\$3,619	\$4,089	\$3,545	\$4,069
5.38	\$3,959	\$4,465	\$3,899	\$4,469
6.14	\$4,319	\$4,855	\$4,269	\$4,875
6.90	\$4,665	\$5,215	\$4,639	\$5,285
7.66	\$5,009	\$5,619	\$4,995	\$5,685

Standard includes single hinged or sliding door in front and wall height of 1810mm



CORRUGATED STEEL FRAME HERITAGE ROOF PRICING

Gable m Front m	Zinc		Colour	
	1.58	2.34	1.58	2.34
1.58	\$2,699	\$3,075	\$2,659	\$3,059
2.34	\$3,139	\$3,545	\$3,119	\$3,545
3.10	\$3,565	\$3,989	\$3,569	\$4,035
3.86	\$3,989	\$4,445	\$4,039	\$4,515
4.62	\$4,909	\$5,359	\$4,895	\$5,399
5.38	\$5,329	\$5,819	\$5,359	\$5,895
6.14	\$5,775	\$6,279	\$5,819	\$6,365
6.90	\$6,209	\$6,725	\$6,285	\$6,849
7.66	\$6,649	\$7,179	\$6,739	\$7,335

Standard includes single hinged or sliding door in front and wall height of 1960mm



Work Shed Range Notes:

1. Longer and shorter fronts and made to order sizes are available on request.
2. Internal portal supplied for fronts exceeding 3.86m.
3. Roof bars supplied for gables 3.1m and above.
4. Steel framed sheds supplied with loose fixing brackets.
5. Finial option available for SF Heritage Range at \$65 each.
6. Roller door only available in steel frame construction. Minimum wall height 2.25m height of opening 1.85m. Maximum wall height 2.4m height of opening 1.95m. Maximum door width 3.0m. Request a quote or see page 18 for roller door pricing.
7. All roofs are non-trafficable. Request a separate quote if a trafficable roof required.

Yes we can do custom sizes and shapes!

BIN LOCKERS

SteelChief's bin locker is a smart way to hide your wheelie bins. With solid steel construction and stylish colours, the locker will withstand the harshest conditions Australia has to throw at it, and look good while doing so.

STANDARD SIZES PRICING

1270mm high

810w x 810d:	One Bin	\$840
1580w x 810d:	Two Bin	\$1140
2350w x 810d:	Three Bin	\$1440
3120w x 810d:	Four Bin	\$1640

All bin lockers 1270mm high.
 Door opening width 740mm x 1150mm.
 Please check that your bin fits. Custom sizes are available. Please discuss with our team.



SMART STORAGE SOLUTIONS



**SEE PAGE 1 TO SELECT COLOURS FOR WALLS DOORS ROOF & WINDOWS! MIX AND MATCH ANY COLOURS YOU LIKE!
 SEE PAGE 22-23 TO SELECT FLOOR DOOR WINDOW EXTRA WALL HEIGHT OPTIONS ETC.**

Call us now for expert advice.

FOWL HOUSE RANGE



S SKILLION ROOF FOWL HOUSE PRICING

Skillion m	Zinc		Colour	
	1.58	2.35	1.58	2.35
0.81	\$765	\$989	\$809	\$1,049
1.58	\$979	\$1,215	\$1,035	\$1,289
2.35	\$1,189	\$1,445	\$1,259	\$1,535
3.12	\$1,399	\$1,669	\$1,489	\$1,779
3.89	\$1,615	\$1,895	\$1,719	\$2,019
4.66	\$1,869	\$2,339	\$1,985	\$2,485
5.43	\$2,085	\$2,569	\$2,215	\$2,729
6.2	\$2,295	\$2,789	\$2,439	\$2,969
Divider	\$379	\$459	\$385	\$475

Standard includes solid sheet single door in skillion side. Wall height front 1950mm back 1800mm. 2.35m skillion side sizes come with roof bar. Divider cost includes a door in the divider front or skillion side. Customer to specify.

U GABLE ROOF FOWL HOUSE PRICING

Gable m	Zinc			Colour		
	1.58	2.35	3.12	1.58	2.35	3.12
1.58	\$1,029	\$1,205	\$1,385	\$1,089	\$1,285	\$1,485
2.35	\$1,279	\$1,475	\$1,665	\$1,349	\$1,569	\$1,785
3.12	\$1,525	\$1,735	\$1,945	\$1,615	\$1,849	\$2,085
3.89	\$1,775	\$1,999	\$2,225	\$1,875	\$2,129	\$2,379
4.66	\$2,299	\$2,555	\$2,809	\$2,415	\$2,699	\$2,985
5.43	\$2,549	\$2,819	\$3,089	\$2,675	\$2,979	\$3,285
6.2	\$2,795	\$3,085	\$3,369	\$2,935	\$3,259	\$3,585
Divider	\$445	\$495	\$549	\$469	\$545	\$619

Standard includes solid sheet single door in the front. Wall Height 1800mm
Divider includes door in divider or in front. Customer to specify.

T FLAT ROOF FOWL HOUSE PRICING

Front x Side m	Zinc		Colour	
	1.58	1.58	1.58	1.58
0.81	\$745	\$785		
1.58	\$955	\$1,009		
2.35	\$1,165	\$1,235		
3.12	\$1,375	\$1,455		
3.89	\$1,585	\$1,679		
4.66	\$1,835	\$1,945		
5.43	\$2,045	\$2,169		
6.2	\$2,255	\$2,395		
Divider	\$335	\$349		

Standard includes door in front wall.
Wall height 1800mm.
Divider includes door in divider or side wall.
Customer to specify.



FOWL HOUSE OPTIONAL EXTRAS



OPTIONAL LAYER BOX

Size: 775 x 450 x 430mm high.
Zinc **\$289**
Layer boxes can be positioned in front back or sides.



OPTIONAL WOODEN FOWL PERCH

Size: 900mm **\$79** Suits 2 birds
1200mm **\$85** Suits 3 birds
Helps strengthen birds feet and keeps eggs clean.

PICTURES:

S 1.58 x 1.58m Skillion roof fowl house. Optional Zinc layer box in front. Zinc **\$979** Colour **\$1035** (prices do not include layer box)

T 2.35 x 1.58m Flat roof fowl house. Shows option of door moved to front wall (no charge!). Zinc **\$1165** Colour **\$1235**

U 3.12 x 3.12m Gable roof fowl house. Zinc **\$1945** Colour **\$2085**

Yes we can do custom sizes and shapes!

AVIARY RANGE



V/W SKILLION ROOF AVIARY PRICING

Skillion m Front m	Zinc		Colour	
	1.58	2.35	1.58	2.35
0.81	\$859	\$1,095	\$895	\$1,145
1.58	\$1,069	\$1,319	\$1,119	\$1,389
2.35	\$1,275	\$1,545	\$1,339	\$1,629
3.12	\$1,485	\$1,775	\$1,565	\$1,875
3.89	\$1,695	\$1,999	\$1,785	\$2,115
4.66	\$1,945	\$2,449	\$2,055	\$2,579
5.43	\$2,149	\$2,675	\$2,275	\$2,825
6.2	\$2,359	\$2,899	\$2,499	\$3,069
Divider	\$379	\$459	\$385	\$475

Standard includes aviary door in front and one sheet wire and dado in each side. Wall heights: Front 1950mm Back 1800mm. Divider cost includes a door in the divider front or skillion side. Customer to specify.

X FLAT ROOF AVIARY PRICING



Side m Front m	Zinc		Colour	
	0.81	1.58	0.81	1.58
0.81		\$829		\$869
1.58	\$785	\$1,035	\$819	\$1,089
2.35	\$975	\$1,239	\$1,025	\$1,309
3.12	\$1,169	\$1,445	\$1,229	\$1,525
3.89	\$1,359	\$1,649	\$1,429	\$1,745
4.66	\$1,629	\$1,935	\$1,669	\$2,005
5.43	\$1,825	\$2,139	\$1,875	\$2,225
6.2	\$2,015	\$2,345	\$2,075	\$2,445
Divider	\$279	\$355	\$279	\$365

Standard includes aviary door in front. 0.81m Sides are solid sheet 1.58m sides have one sheet wire and dado. Wall height 1800mm. Divider cost includes a door in the divider front or side. Customer to specify.



Y FLAT ROOF AVIARIES WITH FULL WIRE FRONTS.

Side m Front m	Zinc			Colour			Optional flight roof
	0.81	1.7	2.47	0.81	1.7	2.47	
0.81	\$504	\$775	\$905	\$541	\$818	\$972	\$59
1.58	\$688	\$975	\$1,115	\$741	\$1,039	\$1,207	\$116
2.35	\$871	\$1,174	\$1,324	\$940	\$1,260	\$1,441	\$178
3.12	\$1,055	\$1,374	\$1,533	\$1,140	\$1,481	\$1,675	\$235
3.89	\$1,238	\$1,573	\$1,742	\$1,339	\$1,702	\$1,910	\$264
4.66	\$1,433	\$1,784	\$1,963	\$1,550	\$1,935	\$2,155	\$321
5.43	\$1,617	\$1,984	\$2,172	\$1,750	\$2,156	\$2,390	\$350
6.2	\$1,800	\$2,183	\$2,382	\$1,949	\$2,378	\$2,624	\$407
Divider	\$253	\$331	\$397	\$253	\$341	\$418	

PICTURES:

- V 1.58 x 1.58m Skillion Roof Aviary MkII.
Zinc \$1069 Colour \$1119
- W 2.35 x 1.58m Skillion Roof Aviary MkIII.
As pictured with Bird Lock Option.
Zinc \$1590 Colour \$1668

CC 3.12 x 3.12m Gable Roof Aviary.

- With optional Hatch in wire.
Zinc \$2104 Colour \$2240
- DD 1.58 x 3.12m WIG Aviary. With optional Divider.
Zinc \$2434 Colour \$1959
- Y 1.58 x 2.47m Flat Roof with full wire front. Optional Flight Roof
Zinc \$1231 Colour \$1232

Standard includes full wire front with door. 0.81 sides are full sheet. 1.70m & 2.47m sides have 900mm wire. Door 490w x 1425h

Call us now for expert advice.



AA DOUBLE HEX AVIARY

Pictured with 1.40m flight.
Zinc **\$3215** Colour **\$3305**

Flight extensions per 0.74m.
Zinc **\$250** Colour **\$260**

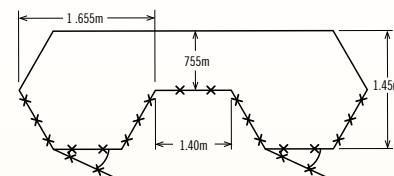

SINGLE HEX WITH FLIGHT

Zinc **\$2028** Colour **\$2098**
Includes 1.875m flight.

Flight extensions per 0.74m.
Zinc **\$235** Colour **\$287**

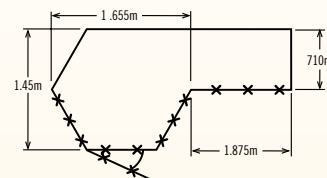

Showing optional hatch in wire.



BB SINGLE HEX AVIARY

Zinc **\$1315** Colour **\$1345**
Wall height 1800mm.

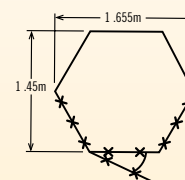

CC GABLE ROOF AVIARY PRICING

Gable m	Zinc				Colour			
	1.58	2.35	3.12	3.89	1.58	2.35	3.12	3.89
1.58	\$1,095	\$1,265	\$1,439	\$1,639	\$1,149	\$1,339	\$1,535	\$1,755
2.35	\$1,339	\$1,529	\$1,725	\$1,929	\$1,415	\$1,619	\$1,835	\$2,069
3.12	\$1,589	\$1,795	\$1,999	\$2,225	\$1,675	\$1,899	\$2,135	\$2,385
3.89	\$1,835	\$2,055	\$2,279	\$2,519	\$1,935	\$2,179	\$2,435	\$2,699
4.66	\$2,359	\$2,609	\$2,865	\$3,129	\$2,475	\$2,749	\$3,035	\$3,335
5.43	\$2,609	\$2,875	\$3,145	\$3,425	\$2,735	\$3,035	\$3,335	\$3,649
6.2	\$2,859	\$3,139	\$3,425	\$3,715	\$2,995	\$3,309	\$3,635	\$3,965
6.97	\$3,105	\$3,399	\$3,705	\$4,009	\$3,255	\$3,589	\$3,935	\$4,279
7.74	\$3,355	\$3,665	\$3,979	\$4,305	\$3,515	\$3,875	\$4,229	\$4,595
8.51	\$3,875	\$4,219	\$4,565	\$4,915	\$4,055	\$4,445	\$4,835	\$5,229
Divider	\$395	\$425	\$509	\$585	\$415	\$459	\$575	\$685

Standard includes aviary door in front and solid sheet gable ends. Wall height 1800mm. Optional wire and dado in gable ends. Divider cost includes a door in the divider or front. Customer to specify. See aviary options.

Aviary Notes:

1. Divider includes door in divider or front.
2. Flat roof with 0.81m sides has wire in front only except Junior as shown.
3. Flights safety doors and false walls can be made to your requirements.
4. Wall heights are same as flat gable and skillion roof ranges.
5. Wire is galvanised welded mesh 12.5 x 12.5 x 1.6mm.
6. Heavy wire 25 x 25 x 2.0mm is available.

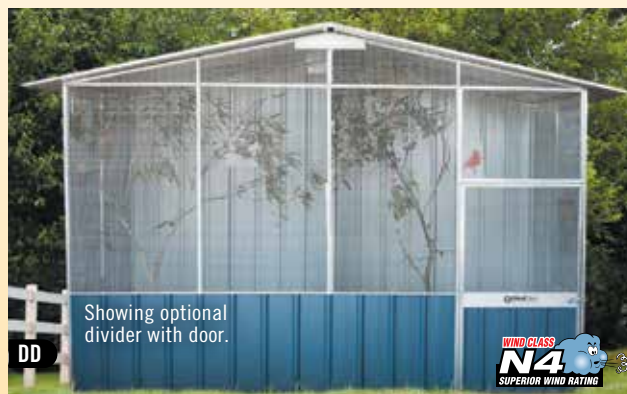

Showing optional divider with door.

DD WIRE IN GABLE ROOF AVIARY PRICING (WIG)

Gable m	Zinc					Colour				
	1.58	2.35	3.12	3.89	Div	1.58	2.35	3.12	3.89	Div
1.58	\$1,395	\$1,639	\$1,879	\$2,125	\$555	\$1,445	\$1,705	\$1,959	\$2,219	\$575
2.35	\$1,639	\$1,899	\$2,159	\$2,415	\$645	\$1,705	\$1,985	\$2,259	\$2,539	\$669

Standard includes door in front and one sheet wire and dado in each side. Wall height 1800mm. Divider cost includes a door in the divider front or side. Customer to specify.

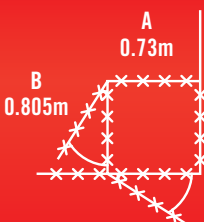

See picture W on opposite page.

AVIARY OPTIONAL EXTRAS

AVIARY BIRD LOCK

Supplied as two panels A+B to suit skillion and gable roof aviaries with fronts greater than 1.58m.
Zinc **\$315** Colour **\$349**
Type and size of aviary must be specified when ordering including door position. Bird lock can be put into rear corner of a new aviary with a full sized door.

Double wire per 0.77m of wire	\$89
Larger aviary door (660mm x 1730mm)	\$85 Wall 1800mm
Larger aviary door (660mm x 1880mm)	\$95 Wall 1950/2100mm
Extra aviary door	\$135
Replace wire & dado with full wire	\$79 per sheet width (0.77m)
Replace solid sheet with full wire	\$145 per sheet width (0.77m)
Replace solid sheet with wire & dado	\$99 per sheet width (0.77m)
Hinged hatch 345 x 350mm high	\$95 in sheet
	\$129 in wire

Upgrade to heavy wire 25x25x2mm Diam.
Add percentage shown to base shed price Zinc 10% colour 8%

Yes we can do custom sizes and shapes!

TIMBER GABLE ROOF



T1

Picture T1: Side: 3.76m x gable 2.44m. Including optional double doors gable end extra single door sliding window skylight and two Tee Handles keyed alike. **\$5147**



T2

Picture T2: Side: 1.94m x gable 1.84m. Including optional sliding window. **\$3114**

GABLE ROOF TIMBER

A range of sheds for those that love the rustic charm of timber. Pricing includes wooden floor.

Side x Gable	1.94 x 1.84	2.54 x 1.84	3.76 x 1.84	1.94 x 2.44	2.54 x 2.44	3.76 x 2.44	1.94 x 3.04	2.54 x 3.04	3.76 x 3.04
Shed	\$2,715	\$3,095	\$3,609	\$3,159	\$3,539	\$4,005	\$3,645	\$4,169	\$5,219
Sub Floor	\$599	\$665	\$749	\$665	\$759	\$815	\$899	\$899	\$1,125

Standard includes single door. Customer to specify which panel and left or right hinge. Supplied as four or six wall panels two or four roof panels plus wooden floor (19mm tongue and groove on 70 x 45mm H4 treated pine bearers).



T5

Picture T5: Side: 1.34m x Gable 1.2m

Bay Box \$1985

T3 VERANDAH OPTIONS: GABLE

Side x Gable	1.94 x 1.84	2.54 x 1.84	3.76 x 1.84	1.94 x 2.44	2.54 x 2.44	3.76 x 2.44	1.94 x 3.04	2.54 x 3.04	3.76 x 3.04
Gable Verandah	\$565	\$565	\$735	\$669	\$669	\$839	\$665	\$665	\$759
Sub Floor Verandah	\$175	\$175	\$175	\$265	\$265	\$265	\$265	\$265	\$265

T4 VERANDAH OPTIONS: SIDE

Side x Gable	1.94 x 1.84	2.54 x 1.84	3.76 x 1.84	1.94 x 2.44	2.54 x 2.44	3.76 x 2.44	1.94 x 3.04	2.54 x 3.04	3.76 x 3.04
Side Verandah	\$565	\$705	\$1,115	\$565	\$705	\$1,115	\$485	\$635	\$985
Sub Floor Side	\$175	\$265	\$329	\$175	\$265	\$329	\$209	\$209	\$275

Additional Options:

- Skylight **\$75** *Double Doors **\$211** (Replaces single door)
- *Sliding Window **\$399** *Extra Single Door **\$211**
- *Louvre Window **\$179** T-Handle **\$75** Shovel or Broom Rack **\$59**
- Steel Clad Door upgrade **\$99** per door customer to specify colour
- Custom Size **\$145**

Optional Upgrade to Pre-Primed Weather boards add 60% to the shed price

See page 23 for steel shelf set options and pricing.

*Customer to specify which panel and door hinge.

Double Door in Skillion Roof Timber models only available in 2.45m and larger sizes.

Picture T6:

Steel Clad Door Upgrade for improved weather resistance. Customer to specify colour. See page 2. for 13 colour options.

As pictured Double Steel Clad Door (Double Doors \$211 plus Steel Clad \$99 x 2) **\$409**



T6

Call us now for expert advice.



T3

Picture T3: Side: 3.76m x gable 2.44m. Including optional double doors gable end extra single door and gable verandah. **\$5354**



T4

Picture T4: Side: 2.54m x gable 2.44m. Including optional double door and verandah. **\$4499**

TIMBER SKILLION ROOF RANGE

SKILLION ROOF TIMBER

Pricing includes wooden floor.

Side x Skillion	1.25 x 0.64	1.25 x 1.24	1.25 x 1.84	1.85 x 0.64	1.85 x 1.24	1.85 x 1.84	2.45 x 0.64	2.45 x 1.24	2.45 x 1.84	3.05 x 0.64	3.05 x 1.24	3.05 x 1.84
Shed	\$1,485	\$1,735	\$2,015	\$1,735	\$2,035	\$2,409	\$2,035	\$2,365	\$2,785	\$2,335	\$2,689	\$3,209
Sub Floor	\$459	\$475	\$565	\$549	\$565	\$689	\$565	\$565	\$705	\$639	\$645	\$825

Standard includes single door. Customer to specify which panel and left or right hinge. Supplied as four wall panels one roof panel plus wooden floor. (19mm tongue and groove on 70 x 45mm H4 treated pine bearers). Double Door in Skillion Roof Timber models only available in 2.45m and larger sizes.

Timber Range Notes:

- Gable Wall Height is 1960mm.
- Skillion Wall Height is 1960mm/1835mm.
- Gable tip height The Bay Box 2.32m.
- Gable tip height is 2.43m for the 1.84m gable.
- Gable tip height is 2.60m for the 2.44m gable.
- Gable tip height is 2.70m for the 3.04m gable.
- Sub floor is 450mm high and is supplied with a set of stairs.
- Single door opening is 800 x 1780mm high.
- Double door opening is 1610 x 1780mm high.
- Doors and windows are positioned in the middle of the panels.
3.76m panels are made up with two 1.8m panels.
Customer to specify door panel.
- Verandah depth 680mm.

Picture T7:

Side: 2.45m x skillion 1.84m.
\$2785

Customer to specify roof colour.



T7

Yes we can do custom sizes and shapes!

TIMBER CUBBY HOUSES

*Optional extras not included in price.

THE HUT

The Hut is our original design and our most popular cubby style. Designed to look like a traditional house, The Hut features a gable roof and a verandah. The Hut can be styled to suit different themes – a shop, a police station, a post office, a house. Just add any of our colourful features and accessories and you can create your own magical space. To include an adventure playground element, why not consider adding an elevation, a sheltered sandpit, slides, scramble nets and a rock wall. The Hut is available in three sizes.

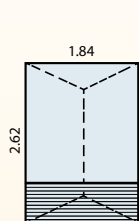

Height 2.0m
Small - \$2,459

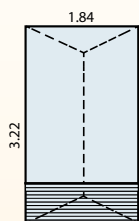

Height 2.0m
Medium - \$2,765

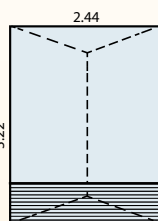

Height 2.11m
Large - \$3,229



As Pictured: Small Hut with door, two windows and a verandah in the gable and one window in the side.



ALL ABILITIES

With a wider doorway, no hinged door and a deeper verandah, the All Abilities cubby is designed for all little adventurers. A ramp and a wider doorway enables easy access for wheelchairs, prams, bikes and trikes. Depending on your requirements, the ramp can be fitted to the front or to the side of the cubby. Decorate this cubby with a raft of accessories including telescopes, periscopes, flower boxes and steering wheels, and turn it into a dazzling castle!

As Pictured: The gable has an 850mm wide door and window opening and a 1280mm deep verandah with same width access ramp. (NB: No door or perspex fitted to these gable openings.) The access ramp can be fitted to left, right or front of verandah - please nominate position at time of order. One standard window in the side.

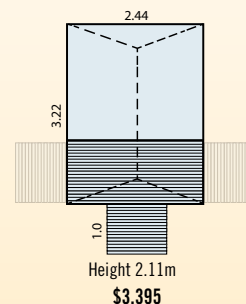

Height 2.11m
\$3,395

THE BEACH SHACK

The Beach Shack is the smallest cubby in our range and is designed with smaller backyards and courtyards in mind. With no verandah, this cubby can be transformed into anything. Add a café servery and turn the shack into an imaginary shop front. Continue along this theme by decorating the shack with a couple of flower boxes and let your child's imagination run wild. Although compact, the shack's multiple windows enhance a feeling of spaciousness inside. The Beach Shack is available in two sizes. Depending on your space, you can also add a sheltered sandpit.

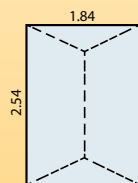

Height 2.0m
Medium - \$2,379

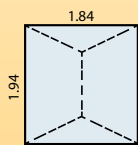

Height 2.0m
Small - \$2,149

As Standard: Door and two windows in the gable, one window in the side. As Pictured: Small Beach Shack with optional* 0.45m elevation kit.



THE FORT

The Fort is a wonderful outdoor play centre the whole family can enjoy. You can choose to install the fort on the ground or add an elevation, which will open up endless adventure possibilities. Once an elevation is included you can look at adding features such as a slide, a scramble net, a rock wall, a fireman's pole, a sandpit. This playground will keep your children entertained for days. The fort is available in two different sizes. It's completely open design allows you to always see your children playing inside.

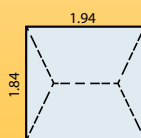

Height 2.0m
Small - \$2,205

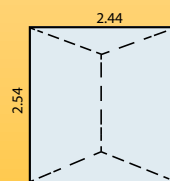

Height 2.11m
Large - \$2,709

As Pictured: Large Fort with an access opening in the center of each wall.



Call us now for expert advice.

ELEVATION KITS

	Elevation	Beach Shack	The Hut	Small Fort	Large Fort
Above Ground	1.2m Kit		\$939	\$755	\$939
In Ground	0.45m Kit	\$415	\$499	\$385	\$515
	1.2m Kit	\$559	\$605	\$785	

Inground Elevations: Posts are 0.6m longer so they can be dug into the ground and concreted in place. Posts can be trimmed to height to suit uneven ground.
 Above Ground Elevations: Includes sandpit boards which form bracing support for posts. No need to dig posts into ground.



0.45m IN GROUND
Elevation Kit



1.2m ABOVE GROUND
Elevation Kit



PRE-PRIMED

Upgrade to pre-primed weather boards add 26% to the cubby price. Must be painted within a couple of weeks after delivery.

ACCESSORIES



\$55 FLOWER BOX



\$69 SKYLIGHT



\$75 BARN DOORS



\$96 EXTRA WINDOW



\$105 BALUSTRADES



\$29 A Pair HAND GRIP



\$49 PERISCOPE



\$45 TELESCOPE

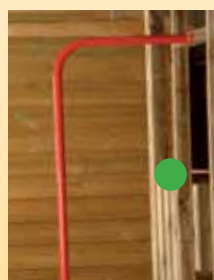

\$285 FIREMAN'S POLE



\$45 STEERING WHEEL



\$65 SHIP STEERING WHEEL

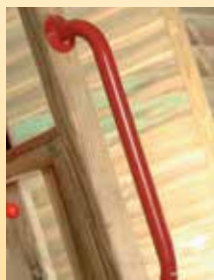

\$65 D HANDLE



10 ROCK CLIMBING WALL
\$379 1.2m Wall



\$355 2.5M SLIDE SUITS 1.2M ELEVATION



\$255 SCRAMBLE NET SUITS 1.2m ELEVATION



\$419 INTERNAL SHELF EXTERNAL AWNING 100mm ELEVATED DECK 900mm OPENING WITH 2 PAINTED DOORS



Small Blackboard \$65 600 x 600 mm
Large Blackboard \$95 1200 x 600 mm

General: Playgrounds should be installed on flat stable ground. Allow 2 metres space from solid structures to ensure safe use. Cubby verandah or Fort openings need to be filled with options or balustrades if elevated. Suitable under surfacing is required as per Australian Standard AS 4685:2014 recommendations. Adult supervision and guidance is required for children using these products.

Yes we can do custom sizes and shapes!

DOG PENS

SINGLE PENS: 1 DOOR

SHED SIZE			RUN LENGTH	ZINC	COLOUR
Front	Side	Height			
1.58m x	0.81m x	1.840m	1.21m	\$1,649	\$1,755
		2.41m	\$2,019	\$2,125	
2.35m x	0.81m x	1.840m	1.21m	\$1,955	\$2,095
		2.41m	\$2,325	\$2,465	
3.12m x	0.81m x	1.840m	1.21m	\$2,255	\$2,429
		2.41m	\$2,625	\$2,799	



DOUBLE PENS: 2 DOORS

SHED SIZE			RUN LENGTH	Zinc	Colour
Front	Side	Height			
2.35m x	0.81m x	1.840m	1.21m	\$2,559	\$2,719
		2.41m	\$3,105	\$3,265	
3.12m x	0.81m x	1.840m	1.21m	\$2,859	\$3,055
		2.41m	\$3,405	\$3,599	

Note: All sizes are approximate. Sizes listed are outside base dimensions. All roofs have overhang both front and back.



NO DOORS

1 DOORS

2 DOORS

WIRE PANELS

1.21m x 1.8m high	No doors	\$269
2.41m x 1.80m high	No doors	\$455
3.12m x 1.8m high	With 1 door	\$755
2.35m x 1.8m high	With 1 door	\$625
1.58m x 1.8m high	With 1 door	\$495

Add single door to any panel \$189

RURAL ELEVATED DOG KENNELS

These are high quality dog enclosures designed for the rural industry. Solid welded construction of frames using a non-rust weld technique, solid snappy latch, welded wire mesh and heavy duty sheeting. Sheeting is a mixture of offcuts and new sheets from our shed operations. Minor dents or scratches won't affect longevity of your kennel. Can be supplied as fully erected (fork on / off your tray) or as pre-assembled panels ready to screw together. Easy installation on your farm. Particleboard 19mm flooring in the kennel, treated pine decking in the run. Doors both ends.

SINGLE

2.40m x 0.81m x 1.40m high
\$2,373



DOUBLE

2.40m x 1.58m x 1.40m high.
\$2,933



Call us now for expert advice.

KENNELS



TIMBER STAINING OPTION
\$79 per kennel/ enclosure

FLAT ROOF KENNELS

Safe long lasting enclosures with excellent accommodation!
Made from high quality materials selected and treated to ensure a safe comfortable and long lasting enclosure for your pet. The roof is supplied hinged to allow easy access to the inside and overhangs the front to provide maximum protection.

SMALL

0.74m Front x 0.49m Sides x 440mm high.
Treated Pine **\$359**

MEDIUM

0.94m Front x 0.64m Sides x 580mm high.
Treated Pine **\$425**

LARGE

1.16m Front x 0.78m Sides x 720mm high.
Treated Pine **\$525**

EXTRA LARGE

1.34m Front x 0.94m Sides x 860mm high.
Treated Pine **\$635**



GABLE ROOF KENNELS

SMALL

0.74m x 0.49m Gable x 670mm high
wall height 440mm. Treated Pine **\$359**

MEDIUM

0.94m x 0.64m Gable x 840mm high
wall height 580mm. Treated Pine **\$425**

LARGE

1.04m x 0.84m Gable x 1030mm high
wall height 720mm. Treated Pine **\$525**

EXTRA LARGE

1.34m x 0.94m Gable x 1220mm high
wall height 860mm. Treated Pine **\$635**

STEEL KENNELS

SMALL

0.81m x 0.81m x 1090mm high
wall height 550mm.

Zinc **\$445**

Colour **\$459**

MEDIUM

0.81m x 1.58m x 1090mm high
wall height 750mm.

Zinc **\$595**

Colour **\$615**

LARGE

1.20m x 1.58m x 1310mm high
wall height 750mm.

Zinc **\$676**

Colour **\$695**



Dog Kennel Notes:

1. Kennels supplied as 6 pre-assembled panels plus the floor and ridge cap.
2. Price includes elevated wooden floor.
3. Available in all SteelChief colours.
4. Flat Roof Kennels - roof overhangs front of kennel by approx 300 - 350mm back of kennel 75mm and sides 70mm.

PET RUNS

0.81m Wide x 930mm high.

	Length	Zinc	Colour	Wire Floor
Small	1.71m	\$895	\$900	\$219
Medium	2.61m	\$1020	\$1050	\$255
Large	3.51m	\$1155	\$1215	\$295



Pet Run Notes:

1. Roof is hinged to allow easy access into the kennel part of the run.
2. Kennel part of run 0.78m x 0.78m x 0.9m high.
3. Roof sheet overhangs front of kennel 270mm approx.
4. Runs come with elevated wooden floor in kennel.
5. Door position can be varied to run end or beside kennel opening Standard position is in the end.
6. Wire is galvanised welded mesh 12.5mm x 12.5mm x 1.1mm.
7. Pet run supplied as 6 pre-assembled panels plus the kennel floor.
8. Available in all SteelChief colours.
9. Made to order sizes available. Request a quote.

STEEL SHED OPTIONS



Steady Rack Bike Rack



Sliding window



Louvre window



Skylight



Tee Handle \$75

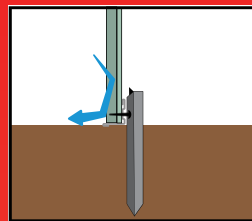

Temporary Anchoring Star Pickets



Shovel/Broom rack \$59 each

BIKE HOOK HANGING BAR:

Side/Gable m	0.81	1.58	2.35	3.12	3.89
	\$65	\$69	\$79	\$85	\$95

BIKE HOOKS \$9 each (catches wheel rim)

STEADY RACK BIKE RACK

\$175

SKYLIGHT FITTED TO ANY SHED:

\$75

SKYLIGHT FITTED TO CORRUGATED SHED:

\$105

SLIDING WINDOWS:

Available in Mist Green Smooth Cream Slate Grey Merino Monolith and Zinc. (Other colours available by arrangement additional costs apply). Glass with aluminium trim 900mm W x 900mm H. Fitted in front or back wall \$399 each. Fitted to gable or skillion end \$479 each. Flyscreen \$80 each.

LOUVRE WINDOWS FITTED IN:

	Galvanized/ZINC
Front or back	\$179
Gable end	\$195
Skillion end	\$195
Five blade glass lockable louvre windows. 730mm x 725mm	

TEE HANDLE:

Standard sheds have a pad bolt(s) To replace a pad bolt with a Tee Handle (2 keys supplied) \$75

EXTRA WALL HEIGHT COST:

To increase standard wall heights add percentage shown to base shed price.

Wall +150mm	Zinc	Colour
Heavy duty construction	12%	12%
Steel frame construction	10%	10%
Wall +300mm		
Heavy duty construction	20%	20%
Steel frame construction	16%	16%
Wall +600mm		
Steel frame construction	22%	22%

TEMPORARY ANCHORS:

This option should only be used in wind protected sites use a minimum of 2 star pickets per panel or 3 pickets for 3.74m panels. Drive star picket (650mm) into ground and anchor shed through Basesmart with a self drilling or tapping screw. This is not N4 rated. This is a DIY friendly option. Short Star Pickets with Self Drilling Screws 450mm \$6.00ea 600mm \$10.00ea

SHOVEL/BROOM RACK:

Hooks over wall 300mm arms \$59

CUSTOM SHED SIZING:

See page 4 for custom sizes Custom roof \$60



DIY WOODEN FLOORING SYSTEM - CHEAPER & EASIER THAN REBATED CONCRETE!

This flooring system is simple fast great value and easy to relocate. A rebated wooden floor offers excellent water seal at the base of the shed and strong attachment to the ground.

	Side/Gable	0.81	1.58	2.35	3.12	3.89
Front	0.81	\$149	\$215	\$275	\$379	\$445
	1.58	\$215	\$369	\$455	\$575	\$685
	2.35	\$275	\$455	\$589	\$745	\$879
	3.12	\$379	\$585	\$799	\$989	
	3.89	\$455	\$709	\$989		

Whilst the wooden floors are simple and effective we do not have engineering specifications and computations for them and as such they are not suitable for cases where a permit is required.

Supplied as pre cut sheets of 19mm particle board flooring and 70 x 45mm treated pine bearers cut to length. Simply lay bearers onto the prepared (flat) site and screw or nail down flooring. Erect shed onto bearers so floor is rebated inside your shed. Then attach your shed to bearers through the Basesmart.

STEEL SHED OPTIONS

REPLACE SINGLE DOOR IN FRONT WITH:	SHED TYPE		
	Heavy duty & Corrugated	Heritage	Steel-frame
Double door in front or back (hinged or sliding)	\$105	\$135	\$180
Double door in gable or skillion end (hinged or sliding)	\$209	\$255	\$255
* Garage doors in front back or gable end	\$565	\$585	\$439
Single door in gable or skillion end (hinged or sliding)	\$135	\$135	\$180
Inward opening door	\$59	\$75	\$115
• 1.8m wide Roller door in any position	NA	NA	\$965
• 2.4m wide Roller door in any position	NA	NA	\$1065
• 3.0m wide Roller door in any position	NA	NA	\$1435
ADD			
Extra single door in front or back (hinged or sliding)	\$105	\$135	\$165
Extra single door in gable or skillion end (hinged or sliding)	\$225	\$265	\$350
Extra double door in front or back (hinged or sliding)	\$180	\$265	\$325
Extra double door in gable or skillion end (hinged or sliding)	\$280	\$375	\$406
* Extra garage doors in front back or gable end	\$629	\$696	\$572
* Garage doors constructed with steel frame door and opening as standard			
• Roller door available in Steel-frame only. See page 9.			
UPGRADE TO STEEL FRAME DOOR AND OPENING			
Single door	\$225	\$225	NA
Double door	\$349	\$349	NA
ALTER DOOR SIZE (1.00m wide max heavy duty/ heritage.)	\$65	\$95	NA
ALTER DOOR SIZE (1.5m wide max steel frame.)	NA	NA	\$109
LOCATE DOOR IN NON-SHEET POSITION	\$49	\$55	\$79

EXPANDABLE METAL STORAGE RACK

600mm deep shelf size. 200kg Weight Capacity (Level Evenly Distributed)

Dimensions (WxDxH)	Shelves	Gross Weight	Price
1200x600x1800mm	4	50kg	\$455
1500x600x1800mm	4	50kg	\$465
2000x600x1800mm	4	60kg	\$475

DOOR OPENING DIMENSIONS	Heavy duty construction	Steel-frame construction
Door opening widths mm		
Standard single door	785	786
Extra wide door	975	976
Double door	1600	1604
Garage door	2384	2384
Extra wide garage doors	n/a	on application
Sliding door	730	730
Double Sliding door	1500	1500
Aviary door	605	-
Roller door	NA	Max 3000
Door opening heights mm	Wall 1800	Wall 1950
Heavy duty construction	1720	1870
Heritage construction	-	1830
Steel frame construction	1750	1900
Aviary door	1425	1425



Sliding Door in Front



Upgrade to Steel Frame Door and Opening



Expandable Storage Rack



Concrete bracket & anchor \$55 packet of 8



Tekkit® Touch-up Paint Pens \$19 each

INSIST on SteelChief

The only Shed with Basesmart Technology!



BUILT WITH basesmart TECHNOLOGY

TRADITIONAL BASE → **PROTECT YOUR LONG TERM INVESTMENT WITH "BASESMART"** → **basesmart**

- Eliminate unsightly trapped debris
- Eliminate premature corrosion
- Higher wind rating

Custom design?

Yes, we can customise your shed, its shape, exact dimensions, door and window position, skylights, shelves, colours and styles...tell us what you want

Think outside the box?

No difficult instructions and a box of bits. Insist on a better shed! SteelChief sheds come as quality pre-assembled panels, **MAKING IT AS EASY AS 1, 2, 3.**

Installation and Concrete?

Yes, SteelChief can install your shed and if required, site preparation, concreting and permits. Contact us to find out if this service is available in your area.



GET PRICE NOW



FOR MORE INFORMATION
Please call 03 5334 1954
Email: management@steelchief.com.au
www.steelchief.com.au

LOCAL DISTRIBUTOR

